

User Manual

Fully Automatic Front Loading Washing Machine

Model: F701202ND
F751202ND

Content

Safety Notice	2
Parts Name	3
Installation	4
Door Lock and Unlock	9
Use of Detergent Box	9
Function Introduction of Main Control Board	10
Introduction of Programs	12
Introduction of Washing Programs	21
Maintenance	22
Varieties of Functions	24
Notice before Washing	26
Not Fault Situation	28
Fault Solving Guidance	29
Specifications	30

Specification

Model	F701202ND	F751202ND
Rated washing capacity	7kg	7.5kg
Rated spinning capacity	7kg	7.5kg
Rated water consumption	49 (L/work cycle)	52 (L/work cycle)
Rated voltage	220V-50HZ	220V-50HZ
Rated washing power	200W	200W
Rated spinning power	380W	400W
Rated heating power	2000W	2000W
Maximum power	2200W	2200W
Washing noise	60dB (A)	60dB (A)
Spinning noise	72dB (A)	72dB (A)
Energy efficiency rate	Class 1	Class 1
clean	1.03	1.03
Power consumption	0.77 (KWH/Cycle)	0.825 (KWH/Cycle)
Water pressure	0.03-1Mpa	0.03-1Mpa
External dimension	595*600*850	595*600*850
Executive standard	GB4706.1、GB4343.1、GB4706.24、GB/T4288、GB4706.26、 GB19606、GB17625.1、GB12021.4、GB/T2828.1；GB/T4288、 GB/T17499-2008	

*Accord with the noise limit stipulated by GB19606.

*The procedures of energy efficiency test are default programs

Half loading/Full Loading The process of energy test is as below:

F701202ND/F751202ND Standard Wash(without soak function)+ Intensive+ rinse 2 times+ water temperature 40C+ Spin Speed 400

Troubleshooting guide

Model: F651003S\F751203N		
Phenomenon	check points	solutions
Washer can't start	<ul style="list-style-type: none"> ● Check if press the power button or start/pause button? ● Is the plug pulling out? ● Is there a power failure? ● Check if cut the leakage protector? 	Press the power button or start/pause button. Connect the plug. Please wait. Open the leakage protector.
Spinning screen shows "UE"	<ul style="list-style-type: none"> ● Check if disassemble the carriage bolt? ● Is the machine placed steadily? ● Are the clothes too small or light? ● Are the locknuts on under the feet tightened up? 	Disassemble the carriage bolt. Place the machine on a steady ground. Add more clothes. Tighten up the locknuts.
Water inflow screen shows "IE"	<ul style="list-style-type: none"> ● Check if turn the tap off? ● Is the water supply cut off or the water pressure too low? ● Are the water inlet pipes frozen? ● Are the filters blocked? 	Open the stopcock. Please wait. Use hot water to unfreeze the pipes. Take out the filters and clean them.
Water outflow screen shows "OE"	<ul style="list-style-type: none"> ● Are the outlet pipe placed too highly? ● Are the outlet pipes frozen? ● Are the outlet pipes blocked? ● Are the floor drain blocked? 	Please put away the outlet pipes and make sure the height within 1M. Use hot water to unfreeze the pipes. Take out the foreign matter and dredge the pipes. Clean the floor drain.
Door trouble screen shows "DE"	<ul style="list-style-type: none"> ● Make sure if start the washer without closing the door well. 	Make sure the door truly closed
Not heating, screen shows "EE"	<ul style="list-style-type: none"> ● Please pull out the plug and call for the after sale service 	
Keep water inletting without stop, screen shows "FE"	<ul style="list-style-type: none"> ● Due to the abnormal of water inlet valve and water level sensor 	Shut the water tap, pull out the plug and call for the after sale service
The wash drum does not running, screen shows "LE" or "CE"	<ul style="list-style-type: none"> ● Please pull out the plug and call for the after sale service 	
Too much bubble	<ul style="list-style-type: none"> ● If adding the amount of detergent is more than the suggested? ● If use the low bubble detergent which is especially for front loading washing machine? 	Add proper amount of detergent. Use the correct type of detergent.
The fault of motor sensor, the screen shows "HE"	<ul style="list-style-type: none"> ● If the position sensor motor fall off or not? 	To firmly connect the sensor and motor stator
The fault of water level sensor, the screen shows "PE"	<ul style="list-style-type: none"> ● If the water level sensor has fallen off or not? ● If the water level sensor pipe blocked or there is a big pressure? 	Tighten the sensor. Open the water pipe excluded congestion or pressure
Power off, the screen shows "PF"	<ul style="list-style-type: none"> ● Power off then power on, push the "power" button, the screen display "PF" to indicate that the power has powered off before. The machine can be in normal operation. 	To push the button of "Start/Pause" can continue the operations before power off. And the other operations can be processed.

Safety Notifications (Please Must Follow)

● In order to prevent the harm or damage to the user or the person and property of others, please make sure to follow the safety issues.



- The risk of electric shock.
 1. Please use 220v, above 10A with ground wire dedicated socket.
 2. When inserting and pulling out the power cord please use the plug, please. Don't use the damaged power cord. When the power cord pin is dirty please wipe clean with dry cloth in time.
 3. Do not use the wet hand to insert or pull out the plug.
 4. Please pull out the plug when finishing, repairing or cleaning.

- The danger of fire and current leakage
 1. Do not allow the washing machine close to the fire, or lighted cigarettes, candles and volatile materials.
 2. Please do not sprinkle the water on the control panel of washing machine.
 3. Please do not put the washing machine in the place of wet and outside place.
 4. Please fix the drain pump and make sure the sewer unobstructed.

- The danger of high temperature
 1. When washing in high temperature, the door glass will be heating. Please do not touch the door glass, especially Children.
 2. When opening the door after high temperature washing, please wait for the temperature cooled down to a safe level and the door will unlocked automatically.

- The danger of getting hurt
 1. Please handle the carton box after removing, don't let the children touch or eat.
 2. Do not allow the children to operate or climb up to the washing machine.
 3. Please close the door after use to avoid the children enter into the drum.

- The danger of injury
 1. Do not put any heavy things on the top of the washing machine.
 2. If you want to move the machine, please remember ask for help.
 3. Please do not ask unprofessional people to repair the machine.





- The danger of damage the cloths
 1. Please do not wash the cloths which is waterproof, like Raincoat, feather products, sleeping bags
 2. Please wash the cloths which can be washed, if you have any doubt, please following the instructions.

- The danger of explosion
 1. Please do not washing the cloths which stained with kerosene, gasoline, thinner, inflammable goods.
 2. Please do not washing when gas leakage.

- If want to open the door when the machine running or other circumstances, please check the water level in the drum first in order to avoid the water overflow tand cause unnecessary loss.

Part name

Attachment specification

Instruction	water supply hose	universal joint	installation instruction	wrench
				

Part name

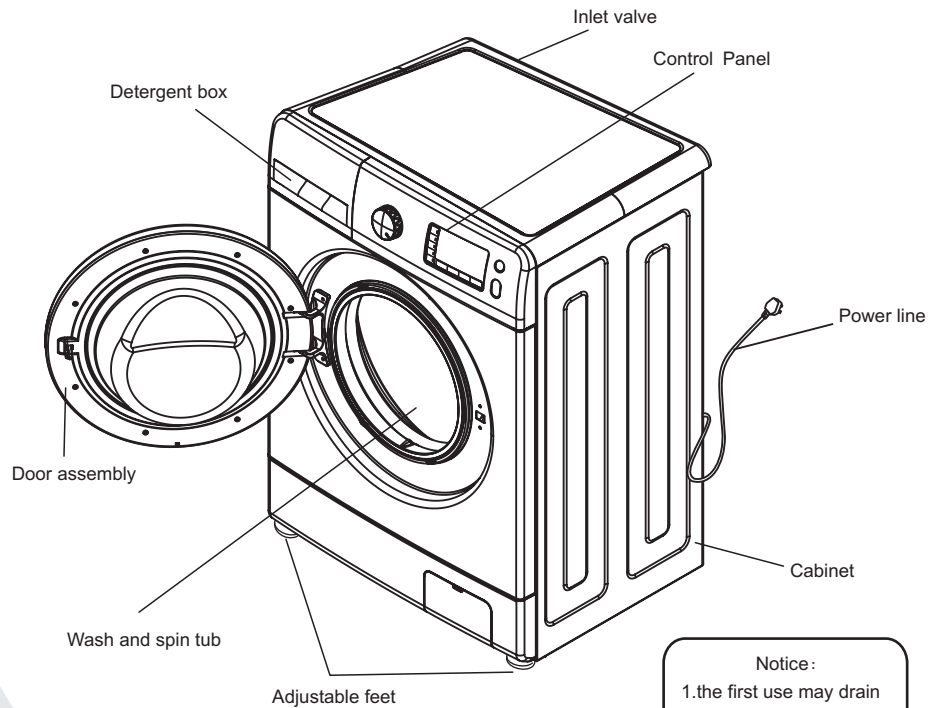

Notice:

- 1.the first use may drain some water out. It's residual water after performance test, belong to the normal phenomenon.
- 2.After each use, please pull the plug and turn off the faucet to prevent accidental flood or fire.

The above picture is just for reference,the detailed information should be based on the real product!

Non-fault conditions

The door can't open.	<ul style="list-style-type: none"> ● he program is running. ● There are clothes between the door and door seals.
There is an odor.	<ul style="list-style-type: none"> ● There may be a smell of rubber because some components are made up of rubber.
There is too little water when wash and rinse.	<ul style="list-style-type: none"> ● Roller washing machine just needs a little water when operating.
No water inflowing.	<ul style="list-style-type: none"> ● Is the tap turned on? ● Is the inlet pipe frozen? ● Are the filters blocked?
Water inflows halfway	<ul style="list-style-type: none"> ● If the water level declines, the washer will supply water automatically.
Water outflows when washing.	<ul style="list-style-type: none"> ● Check if add the detergent with too much bubbles.
Remaining time changes	<ul style="list-style-type: none"> ● If clothes are off center when spin, spinning time will extend to correct the deviation.
There is abnormal noise when spin.	<ul style="list-style-type: none"> ● Check if the power line touches with cabinet. ● Have the transport bolts been dismantled? ● Are there some hairpins or coins in the roller?
The washer can't work after the failure of electricity.	<ul style="list-style-type: none"> ● The washer will stop working after the failure of electricity. When the power is restored, it still can't continue to work. Please press the power button and reset the program.

3. Notes

- When put big and small clothes together, put the big first and they have to be less than half of total clothes. Please don't wash single cloth because it may cause the trouble of imbalance. Please add one or two similar clothes.
- Small clothes like silk stockings and handkerchiefs should be put into mesh bags to wash. Before washing the bra with steel rings, please take the rings off. If it is inconvenient to do this, please put them into mesh bags to prevent the bra slipping into the gap between internal and external tubs.
- Check all pockets and make sure nothing in them. Nails, hairpin, match, pen, coin and key will damage your washer and clothes.
- Zip up all clothes, fix the button and hook and tie the loose belt, make sure that other clothes cannot be damaged by them.
- Firstly use the water with a little detergent to wash the parts with too many stains, such as collar and cuffs, which can make the clothes cleaner.
- Check the door seals and make sure nothing on them.
- Make sure there is nothing in the tub before washing.
- Please use the low bubble detergent specially for front loading washing to wash the cloths.

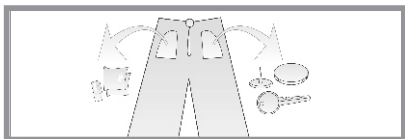
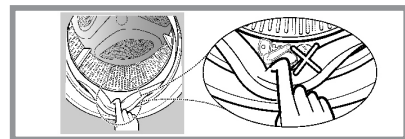
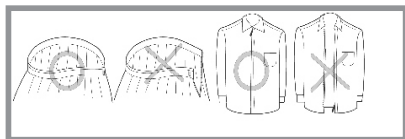
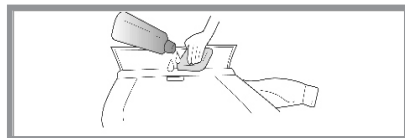
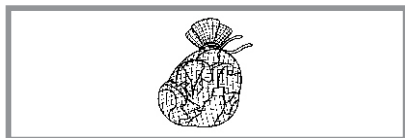

Installation instruction

- Make sure the temperature of the places where the washer is installed or placed above 0°C or put it outside.
- Place the washer correctly according to management standards and regulations.
- Keep the base of washer ventilated when it is placed on the ground with carpet.
- There are too much pests in villages. Please keep the surroundings clean because any damages caused by cockroaches or other pests don't belong to warranty.

Transport bolt

Washers are installed with transport bolt to prevent internal damage in transit.

Dismantle the transport bolt

1. In order to prevent internal damage in transit, 4 bolts are installed. Before using the washer, dismantle the bolt. (see chart 1)
- If the bolts are not dismantled, violent vibration, noise and trouble will be caused.
2. Use the attached wrench to loosen the 4 bolts. (see chart 2)
3. Twist the bolt rubber slightly and then pull out the bolts, keep the bolts and wrench as standby. (see chart 3)
- The bolts should be remounted no matter when to transport the washer.
4. Use attached stopples to seal the screw holes. (see chart 4)

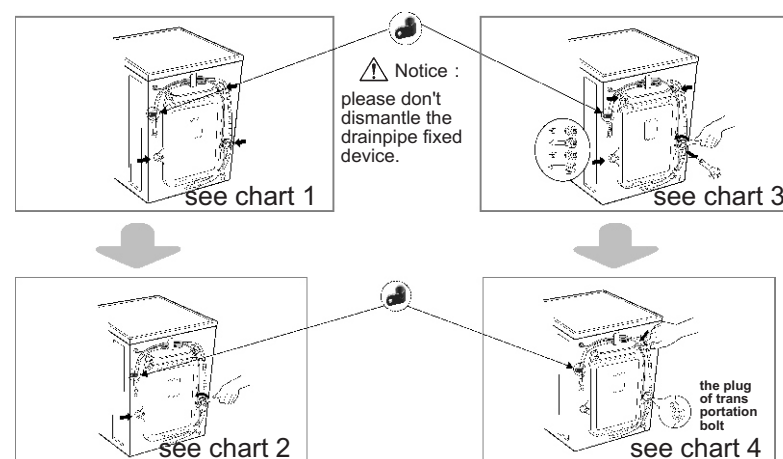

Requires for positions

Horizontal adjustment:

- The slant angle should be less than 1 degree.

Power outlet

- The distance between any side of washer and power outlet should be within 1.5 meters.
- Don't use too many electrical appliances in one outlet.

Environment cleaning

- It's necessary to clean the wall, door and ground.
- Install the washer on a hard and steady ground with floor drain rather than soft blanket or wooden floor.
- Don't put dirty clothes or some other goods on a washer's head cover, otherwise it may impact the normal operation.

⚠ Notice

Power connection

1. Don't use the wiring board or something like that.
 2. If the power lines are damaged, please contact professionals to repair.
 3. After the use of washer, pull the plug and turn the tap off.
 4. Connect the washer with grounded outlet to correspond to the wiring principles.
 5. Place the washer in which is easy to connect the outlet.
- Contact the maintenance center and ask professionals to repair the washer. Laypeople may cause damages and troubles on the washer.
 - Don't put the washer in the place where the temperature is below zero. The pipes will be frozen and break. Moreover, the temperature below zero will damage the programming controller.
 - If move the washer in an environment whose temperature is below zero, please keep the washer at room temperature for a few hours before starting it.

Grounding introduction

- A washer must have the grounding devices. If a trouble happens, the device can reduce the risk of electrical shock. The device is equipped with a cable (including a wire and a grounded plug). The grounded plug must be inserted in an appropriate outlet. If you want to know if the washer is grounded correctly, please contact with professional maintenance staff. If the plug can't match with the outlet, please don't change the plug by yourself.
- Once your washer smokes or emits an odor, please cur the power and contact with professional maintenance staff.

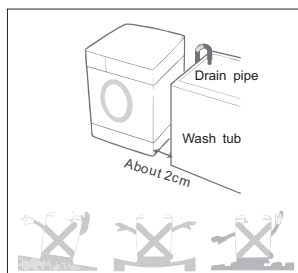

- Push "Start/Pause" button to start the washing machine, it is normal to hear "Clicking" sound, which is door locking sound not an error. If it occurs "dE" warnings, please use hand to push and shut the door. Push two times of "Start/Pause" button to continue running of the machine.
9. **Quick entering into the functions:** Power on, push "Power" button, directly push the following functional button(no need to turn the knob).
 - Push "Start/Pause" to enter standard washing mode directly.
 - Quick entering into the functions: Power on, push "Power" button, directly push the following functional button(no need to turn the knob).
 - "Spin speed" button, the washing machine enter "Spin only" mode (You can choose spin speed), push "Start/Pause" button to start the washing machine.
 10. **Eliminate the sound:** Push "Prewash" button for 3 seconds to start/close the sound.
 11. **Power off memory:** After power off for a while, the machine can continue the programs as before when power on.
 12. **Power off memory:** After power off for a while, the machine can continue the programs as before when power on.

NOTICE

1. Washing guide identification

- Please check cloths washing guide identification, which shows cloths texture and washing method.

2. Classification washing

- Please wash cloth of the same texture, different texture, different water temperature, speed and washing procedure, please split deep colored cloths from white cloths. Split dyed cloths from cotton, otherwise the white cloths would be discolored. If possible, please do not washing high contaminated cloths with clean ones together.
- The degree of pollution (serious, moderate, slight) classify clothes and wash according to the degree.
- color (white, light color, deep color) classify them and wash.
- velveteen (easy to fall off, easy to be adhered) classify the white and the deep color.

6. **Drum clean:** The program of drum clean is use the high water level, high water temperature, high speed to clean the drum and kill the bacteria. The detailed operations ways, please take reference of Page 18.
7. **Child Lock function:** You can lock and unlock the child lock function by pushing 3 seconds when the machine is running.
 - Once the child lock function set, all the other buttons will be locked except the power button.
 - After setting child lock function, the lamp will light up, meanwhile the screen will display "CL" intermittently.
 - When the washing process ending or push "power off" button or default warning, the child lock function cannot be unlocked. It means that the child lock function must be unlocked by hand. When the power on and start the machine, if the child lock function is going on(the lamp of child lock light up and the screen display CL),you need to push "prewash" button for 3 second to unlock the child lock function and then continue to operate the washing machine.
 - Already set the child lock function and then want to change the programs. Firstly remove the child lock function and push the "Start/Pause" button to stop running, then select the required function, then push the "Start/Pause" button to restart running.
8. **Add garment function:** During the process running, if you want to add garment, please push "Start/Pause"button to stop running;
 - After around 5 seconds, it has a sound of unlocking, meanwhile the door lock mark in the screen disappear then you can open the door.
 - Add the additional garment into the drum(Don't let the door clamp clothes, this will cause failure of leakage and error).
 - Forced to open the door part, damage may occur, such as safety problem.
 - When there are many bubble in the inner barrel and plenty of water, open the door, water and foam will flow out .
 - When the inner drum is running, it is in danger status since the temperature of water is above 45°C and there is plenty of water inside. At this time, the door can not be forced to open. If want to open the door, please follow the below instructions:
 - (1) Wait till the inner drum stop running.
 - (2) Wait till the water temperature cool down to below 45°C. If want to open the door when the water temperature is above 45°C, please shut off the power and open the door after 5 minutes.
 - (3) When there is plenty of water inside of inner drum, please restart the power and select "spin speed" button to drain out the water then open the door.
 - Abnormal power off for 2 minutes, you can open the door. During the process of running, the required condition for opening door(water level below door gasket, water temperature below 45°C, spin speed is 0), push "Start/Pause" button, wait till door lock mark disappear, then open the door. When closing the door, press the middle place of the door handle.

Washers should be connected with water inlet. Please use attached new plumbing rather than the old.

In order to ensure the quality, water injection tests are carried out before the washer leaves factory, so there may be water inside the internal tub, door seals and door panel, which are normal.

Water inlet connection

1. The pressure of supply water should be between 30kpa and 1000kpa.
2. Don't abrade the screw thread when connect the inlet pipes with valves.
3. Please install dropping equipment if the pressure of supply water surpasses 1000kpa.

- Two seals are supplied in the connectors of both ends of the pipe to prevent water leaking.
- Turn on the tap and check if the connectors leak.
- Check the pipes regularly. Please change them if necessary.
- Make sure the pipes don't be damaged or twine with each other.

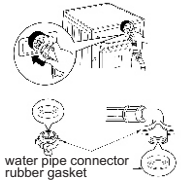
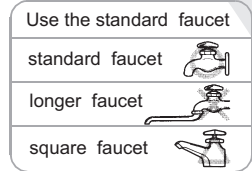

The connection of inlet pipes and taps

- 1 Hold the connecting seat in one hand and press the retaining ring and pull it down by the other hand. Separate the seat and pipe.

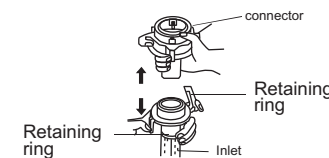

- 2 Loosen the four fixed screws in the top connector and rotate the bottom connector to make enough space between the top and bottom connector so that the screws can be installed.

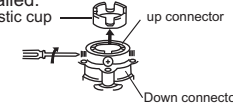

⚠ If the diameter if the faucet is too big, the plastic cup can be removed.

- 3 Adjust the four screws evenly to make the two screws near the wall fully contact with the tap.

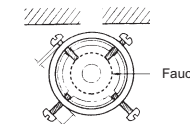

⚠ The screw close to the wall can insert some part.

- 4 Make the top connecting seat block the tap and make the seal fully contact with the tap (please don't take out the seal).

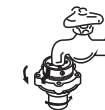

⚠ Please use the standard faucet. The mouth of faucet must be flat. If not flat, please smooth it.

- 5 As shown in picture, two screws to make it in the opposite rotating wall after contact with the faucet with a screwdriver.



- 6 Unscrew the connector till it is tightened (if not tightened, leakage will happen). After unscrewing, the gap between up and down connector is below 3mm.



7 Take Off the Inlet Pipe: Press down the retaining ring of the inlet pipe.



8 Install the inlet pipes, please insert it up into the connector, then undo the retaining ring.

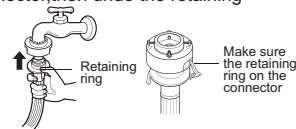

9 Please make sure the connector and the inlet pipe joint tightly.

- please tighten the connector of inlet pipe and inlet valve, turn on the water faucet slowly to check whether leak.
- If leak happens, please turn off the stopcock and install again.
- It will loosen after long period of usage, please stall again as per 1—9.

Remark:

If you use special stopcock. Please install as following processes.

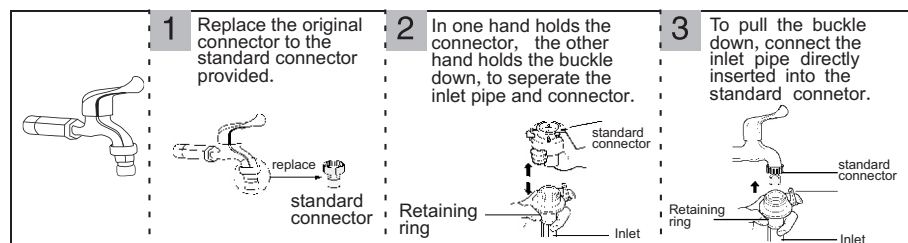

- Such washing machine is designed for home appliances, please do not install it on ship, traveling truck or plane.
- Please turn off the stopcock if long time out of use. (e. g vacation)
- Please remove plug and cancel door lock function to avoid child locking himself/herself inside.
- Packing materials (e. g film, foam) could harm child's safety and cause asphyxia! Attention: MAKE ALL PACKING MATERIEALS OUT OF CHILD REACH.

Install drain-pipe

- Please fix the drain-pipe by a lifting rope.
- For the sake of lightening damage of leak towards ground, please place the drain-pipe correctly.
- In order to avoid siphon, the height of drain-pipe should between (0.85m-1.25m), moreover, the terminal of is should not be placed in water.
- If the drain-pipe is too long, please do not force to insert it into washing machine, which would cause abnormal noise. (Please check sketch map next page)

Function Introduction of Operating Panel



- 1. Prewash:** If the cloths are too dirty, you can choose this program before washing.
- 2. Soak:** After selecting this function, there is a period of time for cloth soaking, which can enhance the performance of washing. If the program has the "weight" function, push one more time for "soak" button can select the function of "weight". If the programs do not have "weight" function, or the "weight" function finished and the screen display the remaining time, push the button of "soak", you can choose "soaking 16mins."- "soaking 24mins"-cancelling soaking" for optional. (The above operation should be done before running.)
- 3. Rinse:** After selecting this function, the machine will heat the water during last time of rinse in order to enhance the performance of rinse.
- 4. Memory:** Used to memory the commonly used programs make it convenient for users to select the used program by push one time button. Push the "memory" button for 3 seconds and hear a chime, at this time this program has been already memorized successfully. If you want to use the memorized program, you can push the program button when it is not running. (Do not push the buttons too long time, just light up the lamp; the above operation should be done when it is not running).
- 5. Prewash Function:** When use "Prewash" function for washing, the delay time is 3 hours to 19 hours.
 - When pushing the button for the first time, the screen display "3:00", then the maximum prewash time can be 19 hours.
 - Push one more time for button, it will increase 1 hour.
 - If want to cancel the prewash function, push "power: button or push one cycle of "prewash" button.
 - The prewash time means from prewash to wash ending time.
 - You should operate the prewash function after selecting the program and before push the button of "start/pause".
- 6. Drum clean:** The program of drum clean is use the high water level, high water temperature, high speed to clean the drum and kill the bacteria. The detailed operations ways, please take reference of Page 18.

Maintenance

When washing machine is frozen

1. Cover stopcock and the universal coupling with hot towel.
2. Take off the inlet pipe, and put it into 50 degree water.
3. Pour into the drum about 2-3L of 50 degree water.
4. Connect inlet pipe, turn on the stopcock and start the washing machine, please check whether inlet and outlet is normal.

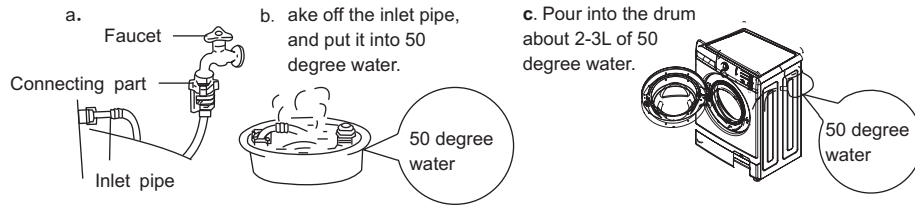

The Clearance of dewatering-pump filter(Suggest: once/monthly)

1. Press fastener on the pump after dewatering and power off, open the lid of water-pump filter.(Attention: if hot water inside, please go ahead after it be cold.)
2. Take off the filter anti-clockwise.
3. Wash the filter.
4. Direct at pump and insert the filter, tighten it clockwise and tighten the lid.

- Attention: a. Please tighten the filter well to avoid leak.
b. Please do not clean during operation.

The Drum Clearance (Suggest once/monthly)

After using for a period, some dirt maybe exist. You can clean the inside and outside of drum by operating the drum procedure.

Attention: please do not put cloths and detergent when clearing the drum.

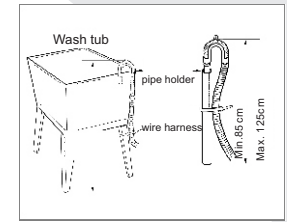
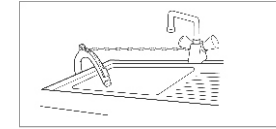
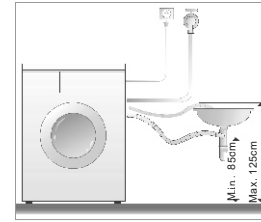

the instruction of installation of pipe

Horizontal Adjustment

- To avoid noise and vibrate by adjusting washing machine level. place it at the room corner preferably.
- If ground not level, please adjust alignment pins. (Do not put wood pieces or something like), please make sure four alignment pins touch ground tightly, and machine level completely.
- Adjust alignment pins
After adjusting alignment pins.
- The diagonal check
Applying force downward on the diagonal of the washing machine, washing machine should not shake. (both diagonal need to check, if the washing machine shake, must readjust adjustable foot.)

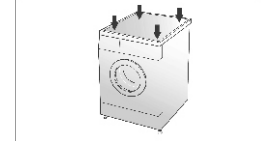
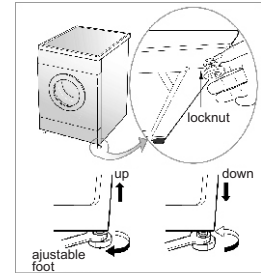
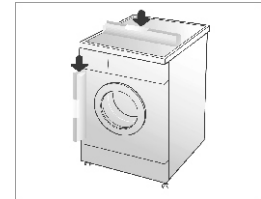

Methods of Door Lock and Remove

DOOR LOCK

- After operating, the door will be locked automatically and “DOO LOCK” light/picture on the panel is lighting.

Remove Door Lock

- When “DOO LOCK” light/picture is lighting, press “START/PAUSE”, WASHING/DEWATERING drum stop operating. Please wait for about 10s, door lock will be removed automatically.
- Unplug directly and wait for about 65s~85S, door lock will be removed automatically.
- Foam overflowing if open the door during operating, please catch foam with towel.
- If temperature is too high, the door can not be opened during operating.
- If water level is too high, the door can not be open during operating.

The Usage Method of the Detergent Box

Synthetic Detergent Powder

- Please dissolve detergent (e.g. soap pieces) before putting into detergent box.

Liquid detergent. Bleach

- Please use detergent with less foam.
- Please use two times water to dilute the concentrated type detergent before putting into detergent box.

Softener

- Please put softener before washing, which will pour into drum automatically when last patch happening.
- When using concentrated type softener, please dilute it with appropriate water.
- Do not exceed MAX mark.

Softener

- Please add softener before last time washing, it will be added into the drum during the last time of rinse.
- Please use concentrated fabric softeners, use the corresponding percentage of water to dilute then pour into the washing machine.
- Do not surpass the mark of "MAX".

- Use special detergent.
- Do not use too much detergent which will cause too much foam and affect washing quality or will cause malfunction.
- Select detergent according to cloths variety, color, water temperature and contamination level.
- Please use moderate detergent to get washing effect and protect environment.

Maintenance

- Please maintenance washing machine to extend service life.
- Before maintenance, please unplug.

Body of washing machine

After washing, please clean it with soft cloth. If much contamination, please use appropriate detergent or soap.

- Do not watering directly.
- Do not use putty-powder, diluent, gasoline, alcohol to clean machine body.

Door Gasket Ring

After washing, please remove contamination, wastepaper and so on, if foreign matter exists, please remove.

The Clearance of Detergent Box

Please clean the detergent box regularly. Pull it out and wash with clean water, then insert back.

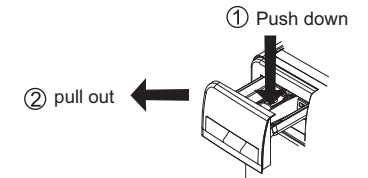

The Clearance of Universal coupling (Suggest:Once/ half year)

- If waste accumulated, it will influence water inlet speed.
 - 1.Take off the soft pipe from the universal coupling side.
 - 2.Take off the screwing device according to the arrow showed.
 - 3.Wash the inside of the screwing device.
 - 4.Install the cleaned crewing device with the inlet soft pipe.

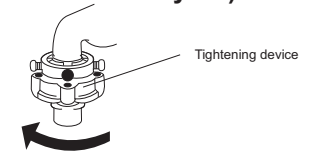

The clearance of inlet water valve (Suggest:Once/ half year)

- 1.Take off the soft pipe from washing machine side.
- 2.Take off the filter net from water valve.
- 3.Clean the filter net with tooth-brash.
- 4.Install the soft inlet pipe.

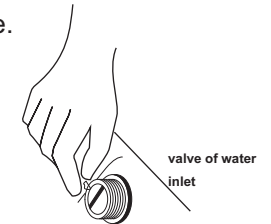

Model No. :F701202ND/F751202ND

Program	Temperature (°C)	Rinse (times)	Spin Speed (Run/Min.)	Time(m)	Max.Load (Kg)	Cloth Materials	Soak (Additional)	Wash options
Standard /Cotton	40°C (cold, 30°C, 60°C, 96°C)	3 (1, 2, 4, 5)	1000(0, 400, 800, 1200)	96	Rated	Normal Cotton Fabric	YES	Cotton(Saving time, Intensive)
Eco	30°C (cold, 40°C, 60°C)	2 (1, 3, 4)	1000(0, 400, 800)	59	≤4.0	Normal Cotton Fabric	NO	Saving time (Cotton)
Synthetic	40°C (cold, 30°C, 60°C)	3 (1, 2, 4, 5)	1000(0, 400, 800)	88	Rated	Synthetic Fabric	YES	Cotton(Saving time, Intensive)
Duvet	40°C (cold, 30°C)	2 (1, 3, 4)	800(0, 400)	80	≤5.0	Sheet/ Curtain	YES	Cotton(Saving time, Intensive)
Delicate	30°C (cold, 40°C)	2 (3, 4)	800(0, 400)	63	≤2.0	Gauze/Silk Fabric	NO	Cotton(Saving time, Intensive)
Sports Wear	cold(30°C, 40°C)	2 (1, 3)	800(0, 400)	46	≤4.0	Apply to Machine -washable Sportswear	NO	Cotton(Saving time, Intensive)
Wool/ Hand wash	40°C (cold, 30°C)	2 (3, 4)	800(0, 400)	51	≤2.0	Apply to Machine -washable Wool Fabric	NO	Cotton (Intensive)
Mix	cold(30°C, 40°C)	3 (1, 2, 4, 5)	800(0, 400)	83	Rated	Normal Cotton Fabric and Synthetic Fabric	NO	Saving time (Cotton, Intensive)
Down Jacket	30°C (cold, 40°C)	3 (2, 4)	800(0, 400)	77	≤2.5	Apply to Machine -washable Down Jacket	YES	Saving time (Cotton, Intensive)
Baby Care	60°C (cold, 40°C)	3 (2, 4, 5)	800(0, 400, 1000)	138	≤4.0	Infant clothing need to remove bacterias and mits	NO	Saving time (Cotton, Intensive)
Tub Clean	60°C	2	800	75	≤4.0	—	NO	Saving time (Cotton, Intensive)
Quick 15'	cold(30°C, 40°C)	1 (2, 3)	800(0, 400)	15	≤2.0	Clothes to be changed Friequently, not too dirty and thin clothes	NO	Saving time (Cotton, Intensive)
Spin only	—	—	1000(0, 400, 800, 1200)	12	Rated	Normal Cotton Fabric and Synthetic Fabric	NO	—
Rinse+ Spin	—	1 (2, 3)	1000(0, 400, 800, 1200)	18	Rated	Normal Cotton Fabric and Synthetic Fabric	NO	—

Instruction:

- 1 .The needed time can be changed due to water pressure, drain condition, clothing textile, weight, water temperatue changing.
- 2 .During the process of washing, the time of washing and spinning will be different with the real running time.
- 3 .During the process of washing, the real display time will beat according to sensing the weight chaning of clothing.
- 4 .Due to different weight of clothing and detergent, if the spin speed is too low, the rinse performance will not be good, please increase times of rinse.
- 5 .The data in the chart can be different from different models.
- 6 .When editing the default program as energy efficiency program, washing time will increase automatically.
- 7 .Delicate and down jacket program can be only used in model F751202ND.

Function Introduction of Operating Panel(One)

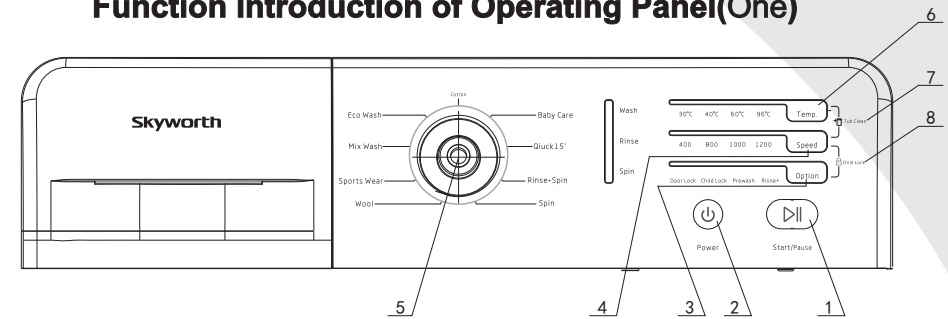

1 START/PAUSE

- Press START button to start operation.
- Press PAUSE button to stop, and press it again to continue.

2 POWER

- Press it to turn off/on power.
- Procedure over, power off automatically.

3 SELECT

- Press it to select additional function.

4 “Washing” button

- When push the power button to start the machine and select the program, you can choose the washing mode (saving time, standard, intensive) by this button.

5 “Rinse” Button

- When push the power button to start the machine and select the program, you can choose the times of rinse by this button, which can make better washing performance.

6 “Temperature” button

- When push the power button to start the machine and select the program, you can choose proper water temperature according to the material of cloths.

7 “Spin” button

- When push the power button to start the machine and select the program, you can choose different spin speed (1200, 1000, 800, 400, avoid dehydration).

8 ” Additional Function” Button

- According to your request, you can add the additional function to the basic programs. The additional function will be different according to different basic programs. (Please take reference the additional functions introduction in details).

9 Child Lock Lamp

- To avoid the children wrongly operations
- If you want to start child lock function, you should push prewash button for 3 seconds during the running process of washing machine. To unlock child lock function, you can push prewash button for 3 seconds during the running process or under non- running process. (Please check the detailed introduction of child lock function in the “additional function introduction”).

10 Display Screen

- To display the remaining time or prewash time
Remaining time gradually reduce in accordance with the washing.
- During the process of washing, if there is a abnormal phenomenon, the screen will display the error code accordingly.
- If the remaining time is different with the real time, the program will adjust according to the real situation. It is not an error.
- If the program has self-weight function, the screen will display “- - -”. If washing machine is in the process of weighting, the screen will flash “-”. If the weighting function ends, the screen will display the remaining time of washing.

11 The reminding window of washing status

- There are four indicator lamp on the top, represent weighting, washing, rinse and spin.
- When setting the programs before washing, if some indicator lamp lights, it means that this washing program has the following washing process; When the machine is running, if one indicator lamp lights, it means the current washing process is under this status; If some indicator lamp always flash, it means that the following washing process include the corresponding programs.

The introduction for single spinning program

The machine will not wash and rinse, only spin.

1. preparation for washing
 - Open the door, put clothes in and closes the door.
2. Press the power button, connect the power.
3. Rotate the program button and choose the “single spinning”
 - The default rotate speed is 88r/m, pressing “rotate speed” button can adjust the speed.
4. Press the start/pause button
 - Begin to drain away water and spin.
5. When the program ends, it will have a hum sound.

- If you want to change the current settings during the process of spin, please push the “Start/Pause” button to stop the washing machine and then push “spin speed” button to change.
- During the process of spinning, the actual spinning speed may be inconsistent with the program speed, which is because the washer adjust the speed according to the balance between clothes.
- There may be rhythmic drone during spinning, which is the normal voice of drain bump rather than the machine fault.

Rinse and Spin function Introduction

The machine will not wash, only rinse and spin.

1. Prepare washing
 - Open the door and put the cloths then close the door
2. Push “Power” button and connect to the power
3. Turn the program button to choose “Rinse+ Spin” program
 - The washing program will be selected automatically. Take reference on page 21.
 - Choose the proper spin speed and rinse times.
4. Push “Start/Pause” button to start washing.
5. When the program ends, it will have a hum sound.

- If you want to change the current setting, please push “Start/Pause” button first and stop washing, then push “Rinse” and “Spin Speed” button to reset.
- The Spin speed can be selected the highest, but the temperature cannot be set.

- If you want to change the current setting during the process of washing, please firstly push "Start/Pause" button to stop the operation, then to reset different programs.
- This mode can not adjust the temperature, spin speed and rinse times, but can adjust the washing time.
- During the process of setting tub clean program, it will alternately display washing remaining time and "CL n". During the process of operating, it will only display remaining time.
- When the program ends, open the door and dry the inner part of washing machine in order to prevent the deformation of gasket.
- If there are children at home, please don't open the door for too much time.

Quick Wash 15' Program Introduction

To wash clothes that are changed frequently, not too dirty and thin clothes

1. Prepare for washing.

- Open the door, put the clothes then close the door.
 - Taking the detergent box and add detergent then close it.
 - Connect the water inlet pipe well and make sure the faucet is running.
2. Push "Power" button and connect to the power.
3. Turn the program button to choose "quick wash" program
- The washing program will be selected automatically. Take reference on page 21.
 - Choose the needed water temperature, spin speed, rinse times and washing intensity.
4. Push "Start/Pause" button to start washing.
5. When the program ends, it will have a hum sound.

- If you want to change the current setting during the process of washing, please push "Start/Pause" button first and stop washing, then push button to reset.
- In order to prevent clothing damage, speed cannot set the highest speed, the temperature cannot be set to "cold", "30°C", "40°C" prevent the door from distorting.
- In order to ensure the washing effect, washing is suitable for the washing capacity under 2 kg.

The introduction of function and program

Usage of routine clothes

1. Preparations

- Open the door put clothes in and close the door.
- Pull out the detergent box, add detergent and close the box.
- Connect the inlet pipes and make sure the tap turned on.

2. Press the power button

3. The programs can be selected according to requirements.

- Standard-Eco-Synthetic-Duvet-Delicate-Sports Wear-Wool/Hand wash-Mix-Down Jacket-Baby Care-Tub Clean-Quick 15'-Spin Only-Rinse+Spin

4. Press start/pause button and begin to wash

5. Washing Ending

- The screen displays "End" with a hum.
- Open the door and take out the cloth.
- Pull out the plug and close the faucet.

The usage of self-compiled program

You can use it when need to set washing intensity, rinse times, water temperature, spin speed.

1. Prepare to wash

- Open the door, put clothes in and close the door.
- Pull out the detergent box, add detergent and close the box.
- Connect the inlet pipes and make sure the tap turned on.

2. Press the power button

3. The programs can be selected according to requirements.

4. Push "wash"/"rinse"/"temperature" button to set washing intensity, rinse times, water temperature, spin speed.

5. Press the start/pause button to start washing.

6. When the program ends, it will have a hum sound.

- The screen displays "End" with a hum.
- Open the door and take out the cloth.
- Pull out the plug and close the faucet.

Cotton Program Introduction

This program is suitable for the clothes which are moderate or mild dirty, like cotton, beddings, underwear, towels and shirt, etc...

1. Preparation for washing

- Open the door, put the clothes then close the door
- Taking the detergent box and add detergent then close it.
- Connect the water inlet pipe well and make sure the faucet is running.

2. Push "Power" button and connect to the power

3. Turn the program button to choose "cotton" program

- The washing program will be selected automatically. Take reference on page 21. page 21.
 - Choose the needed water temperature, spin speed, rinse times and washing intensity.
4. Push "Start/Pause" button to start washing
5. When the program ends, it will have a hum sound.

- If you want to change the current setting during the process of washing, please push "Start/Pause" button first and stop washing, then push button to reset.
- When the washing machine washing towel, the yarn will be squeezed, washing will get rough surface, using the fiber softening agent, to prevent this kind of phenomenon happens to the greatest extent.

The introduction for energy-saving program

To wash the clothes that is not too dirty, it will save time and water.

1. Preparation for washing

- Open the door, put clothes in and closes the door.
- Pull out the detergent box, add detergent and close the box.
- Connect the inlet pipes and make sure the tap turned on.

2. Press the power button, connect the power.

3. Rotate the program button and choose the "energy-saving"

- The washing program will be selected automatically. Take reference on page 21.
 - Choose the needed water temperature, spin speed, rinse times and washing intensity.
4. Press the start/pause button and begin to wash.
5. When the program ends, it will have a hum sound.

- When the washer is working, if you want to change its setting, please press the start/pause button to stop running temporarily and then choose the program you need.

Baby Care Function

This program is to wash infant clothing, allergy people clothing and clothing need high temperature bacteria suppression mite.

1. Prepare for washing

- Open the door, put the clothes then close the door.
- Taking the detergent box and add detergent then close it.
- Connect the water inlet pipe well and make sure the faucet is running.

2. Push "Power" button and connect to the power

3. Turn the program button to choose "quick wash" program

- The washing program will be selected automatically. Take reference on page 21.
 - Choose the needed water temperature; spin speed, rinse times and washing intensity.
4. Push "Start/Pause" button to start washing
5. When the program ends, it will have a hum sound.

- If you want to change the current setting during the process of washing, please push "Start/Pause" button first and stop washing, then push button to reset.
- Reach the best temperature aseptic divide mite effect, can choose "9 6 °C".
- When taking the clothes out, pay attention to the internal heating steam. Before opening the door to take out clothes, please

Tub Clean Function

Tub Clean program is to use high water level, high temperature and high spin speed to clean and sterilize the inner tube.

1. Preparation for washing

- Please make sure nothing in the tub before cleaning.
- Open the distribution box, add the liquid bleach in the main box.
- Don't add detergent or laundry detergent to prevent causing too much foam.
- Close the distribution box.
- Please make sure the inlet pipes connected well and the tap turned on.

2. Press the power button, connect the power.

3. Turn the program button to choose "tub clean" program.

- The washing program will be selected automatically. Take reference on page 21.
4. When the program ends, it will have a hum sound.

Mix Washing Function

This function can be used to wash mix clothes like cotton, synthetic and so on (please do not mix wash the clothes that easily rub off).

1. Prepare for washing

- Open the door, put the clothes then close the door
- Taking the detergent box and add detergent then close it.
- Connect the water inlet pipe well and make sure the faucet is running.

2. Push "Power" button and connect to the power

3. Turn the program button to choose "duvet" program

- The washing program will be selected automatically. Take reference on page 21.
- Choose the needed water temperature, spin speed, rinse times and washing intensity.

4. Push "Start/Pause" button to start washing

5. When the program ends, it will have a hum sound.

- If you want to change the current setting during the process of washing, please push "Start/Pause" button first and stop washing, then push button to reset.
- In order to prevent clothing damage, speed cannot set the highest speed, the temperature cannot be set to "60 °C and "96 °C
- Please separate white or bright color clothes from dark clothes.

Down Jacket Function

Washing down fill clothing.

1. Prepare for washing

- Open the door, put the clothes then close the door
- Taking the detergent box and add detergent then close it.
- Connect the water inlet pipe well and make sure the faucet is running.

2. Push "Power" button and connect to the power

3. Turn the program button to choose "duvet" program

- The washing program will be selected automatically. Take reference on page 21.
- Choose the needed water temperature, spin speed, rinse times and washing intensity.

4. Push "Start/Pause" button to start washing

5. When the program ends, it will have a hum sound.

- If you want to change the current setting during the process of washing, please push "Start/Pause" button first and stop washing, then push button to reset.
- In order to prevent clothing damage, speed cannot set the highest speed, the temperature can only be set to "cold", "30 °C and "40 °C

Synthetic Program Introduction

To wash the synthetic clothes

1. Preparation for washing

- Open the door, put the clothes then close the door.
- Taking the detergent box and add detergent then close it.
- Connect the water inlet pipe well and make sure the faucet is running.

2. Push "Power" button and connect to the power

3. Turn the program button to choose "synthetic" program

- The washing program will be selected automatically. Take reference on page 21.
- Choose the needed water temperature, spin speed, rinse times and washing intensity.

4. Push "Start/Pause" button to start washing

5. When the program ends, it will have a hum sound.

- If you want to change the current setting during the process of washing, please push "Start/Pause" button first and stop washing, then push button to reset.
- In order to prevent clothing damage, speed cannot set the highest speed, the temperature cannot be set to "96 °C

Duvet Program Introduction

The cloths have the machine-washable mark, like bedding, bed sheets, curtains, etc

1. Prepare for washing

- Open the door, put the clothes then close the door
- Taking the detergent box and add detergent then close it.
- Connect the water inlet pipe well and make sure the faucet is running.

2. Push "Power" button and connect to the power

3. Turn the program button to choose "duvet" program

- The washing program will be selected automatically. Take reference on page 21.
- Choose the needed water temperature, spin speed, rinse times and washing intensity.

4. Push "Start/Pause" button to start washing

5. When the program ends, it will have a hum sound.

- If you want to change the current setting during the process of washing, please push "Start/Pause" button first and stop washing, then push button to reset.
- In order to prevent clothing damage, speed cannot set the highest speed, the temperature cannot be set to "60 °C and "96 °C
- The electric blanket and carpet cannot be washed. (It will damage the machine and clothes).

- Put the clothes in the washing drum properly and uniform when spinning, in order to avoid large vibration and drying time may be extended.
- Heavy clothes can not be entanglement, need to put inside the washing machine after shaking loose.
- Uneven clothes can lead to not spinning(display UE), take out again in the after washing to shake loose.

Delicate Function

Washing gauze, silk underclothes.

- 1.Prepare for washing
 - Open the door, put the clothes then close the door.
 - Taking the detergent box and add detergent then close it.
 - Connect the water inlet pipe well and make sure the faucet is running.
- 2.Push "Power" button and connect to the power.
- 3.Turn the program button to choose "duvet" program.
 - The washing program will be selected automatically. Take reference on page 21.
 - Choose the needed water temperature, spin speed, rinse times and washing intensity.
- 4.Push "Start/Pause" button to start washing.
- 5.When the program ends, it will have a hum sound.

- If you want to change the current setting during the process of washing, please push "Start/Pause" button first and stop washing, then push button to reset.
- In order to prevent clothing damage, speed cannot set the highest speed, the temperature cannot be set to "60 °C and "96 °C.

Sports Wear Function

Wash the machine- washable sports clothes

1. Prepare for washing
 - Open the door, put the clothes then close the door
 - Taking the detergent box and add detergent then close it.
 - Connect the water inlet pipe well and make sure the faucet is running.
2. Push "Power" button and connect to the power
3. Turn the program button to choose "duvet" program
 - The washing program will be selected automatically. Take reference on page 21.
 - Choose the needed water temperature, spin speed, rinse times and washing intensity.

- 4.Push "Start/Pause" button to start washing
- 5.When the program ends, it will have a hum sound.

- If you want to change the current setting during the process of washing, please push "Start/Pause" button first and stop washing, then push button to reset.
- In order to prevent clothing damage, speed cannot set the highest speed, the temperature cannot be set to "60 °C and "96 °C

Wool/Hand Wash Function

Wash wool fiber texture, such as machine washable wool fabrics, etc.

- 1.Prepare for washing
 - Open the door, put the clothes then close the door
 - Taking the detergent box and add detergent then close it.
 - Connect the water inlet pipe well and make sure the faucet is running.
- 2.Push "Power" button and connect to the power
- 3.Turn the program button to choose "duvet" program
 - The washing program will be selected automatically. Take reference on page 21.
 - Choose the needed water temperature, spin speed, rinse times and washing intensity.
- 4.Push "Start/Pause" button to start washing temperature, dewatering speed and appoint time.
5. When the program ends, it will have a hum sound.

- If you want to change the current setting during the process of washing, please push "Start/Pause" button first and stop washing, then push button to reset.
- In order to prevent clothing damage, speed cannot set the highest speed, the temperature cannot be set to "60 °C and "96 °C
- After washing completed, take the clothes in time, drying, after shaking loose plastic deformation in order to avoid placing time is too long.
- Please separate white or bright color clothes from the dark clothes for washing.
- Using special wool detergent can reduce clothing damage, improve the washing effect.